

Windows & Façades

Product Range



illbruck adds perfection.... to all your sealing and bonding projects. Whether it be windows, façades, interiors or exteriors, a major construction scheme or a minor refurbishment job - we offer the right set of products, services and expertise to lessen your workload and improve the overall climate of buildings. Making it perfect.

illbruck products ensure sustainable, top quality solutions. They meet all relevant government requirements, help to lower energy consumption and contribute to a healthy living environment. The products are regularly checked by independent materials testing institutes for performance, durability, safety and adherence to low emission standards. This has resulted in numerous seals of approval for the different products as well as for the company.

illbruck is a brand of tremco illbruck, a European manufacturer and service provider of high performance building materials.





- 04 Where Our Products are Used
- 06 The i3 System
- 08 Thermal Window Installation System

Products

- 10 Impregnated Foam Tapes
- 13 Intelligent Membranes
- 16 EPDM & Butyl Membranes
- 18 Building Protection Range
- 21 High Performance Adhesives
- 23 PU Foams
- 26 High Performance Sealants
 - 26 Silicone Sealants
 - 29 Hybrid Sealants
 - 30 Bituminous Sealants
 - 31 Fire-Rated Sealants
- 32 Pressure Sensitive Adhesive Tapes
- 34 Protection Tapes and Films
- 35 Cleaners, Primers, Guns & Accessories
- 40 Sealant Primers - Section Table
- 42 Glossary, Certifications & Memberships
- 43 Other tremco illbruck brands

For the latest updates and product information, visit our website www.illbruck.com





Product Applications

 <p>1 TP652 Page 12</p>	 <p>2 SP525 Page 30</p>	 <p>3 ME508 Page 13</p>	 <p>4 SG365 Page 33</p>
 <p>5 FM330 Page 23</p>	 <p>6 ME501 Page 4</p>	 <p>7 FA870 / FA880 Page 26/67</p>	 <p>8 ME010 Page 18</p>



Consult you local tremco illbruck sales representative for more applications.

 <p>9 ME012 Page 19</p>	 <p>10 SP510 Page 29</p>	 <p>11 ME315 Page 19</p>	 <p>12 ME316 Page 19</p>
 <p>13 OS111 Page 30</p>	 <p>14 TN021 Page 32</p>	 <p>15 TP600 Page 10</p>	 <p>16 ME241 Page 15</p>

High Performance Window Systems Intelligent Seals for Airtight Internal & Weather-tight External Joints

As building regulations change, new solutions and practices are required. The problem of uncontrolled air leakage from buildings has grown in recognition with the amendments to Part L in 2006, 2010 and 2013, requiring energy reduction targets to be addressed and the incorporation of mandatory air leakage testing.

Highly energy efficient windows are now invariably specified and to maximise this investment, tremco illbruck offer a range of products to ensure that the benefits arising from such selection are complemented by a high quality installation. The illbruck i3 system enables performance to the highest standard and will restrict air leakage to below 1 m³/hr.m² @ 50 Pa, ensuring compliance with Passive House standards.

The innovative "i3" system encompasses the concept of sealing out weather whilst sealing in comfort and energy savings. It incorporates a choice of products to effectively seal on three levels: Weather tight (but vapour permeable) externally, airtight internally, with a thermal and acoustic insulation layer between.

By selecting the appropriate products, a simple, cost effective installation will benefit the building owner / occupier for years to come and the long-term savings can be enjoyed by all.

A typical example of the i3 system comprises of:

TP600 - an impregnated foam tape which forms a vapour permeable external weather-tight seal.

FM330 Pro Foam Air Seal - a PU Expanding Foam which insulates giving the installation improved thermal and acoustic performance.

ME508 Duo Membrane EW/F - intelligent membrane used internally to create an airtight installation.

With the "i3" Window Sealing System, tremco illbruck can provide a state-of-the-art universal sealing system for the perimeter sealing of windows. Other i3 system options are given on page 7.

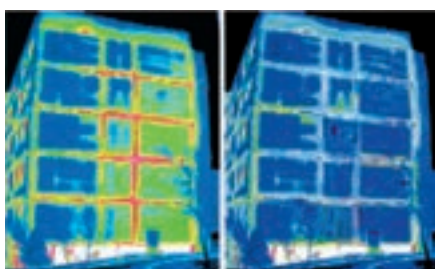

Before & After: This thermal image shows the impact of the i3 system on a building's thermal loss

State-of-the-Art Window Sealing!

Provides . . .

-  Weather seal for wind-driven rain
-  Vapour permeability
-  Thermal insulation
-  Acoustic insulation
-  Internal airtight seal

The BBA Approved i3 System



Sash window in a check reveal using the i3 system



Traditional casement window detail with the i3 system

- 1 TP600 Compriband 600
- 2 FM330 Pro Foam Air Seal (BBA accreditation pending)
- 3 ME508 Duo Membrane EW/F (BBA accreditation pending)

The i3 Window Sealing System

How it works: "inside tighter than outside"

Proper sealing is an effective interaction of the outer, middle, and inner sealing levels on the principle of "inside tighter than outside." By selecting appropriate products from our seven system components, various combinations can be created to suit the installation situation. The resulting system will meet all the requirements of modern sealing conventions.

The result:

An externally weatherproof but vapour permeable system, which also prohibits the warm internal air penetrating the joint and forming condensation, a problem which can lead to a reduction in the level of thermal insulation, damage to building components and mould formation.

- a) Exceeds 600 Pa as per DIN EN 1027 Imperviousness to Driving Rain and DIN 18542 (testing of sealing of outside wall joints with impregnated sealing tapes)
- b) Effective filling and insulation of the window joint seal
- c) Airtight to UK Building Regulations Document L and DIN 18542 & DIN EN 1026 (testing window and door air permeability). Also meets Passive House airtightness requirements.

10-year "i3" performance guarantee*

The "i3" Window Sealing System from illbruck comes with a 10-year guarantee* for the performance of the joints.

BBA Accreditation

The "i3" system and its individual components are BBA approved, proving their fitness for purpose.

* Under the conditions specified by tremco illbruck - available on request

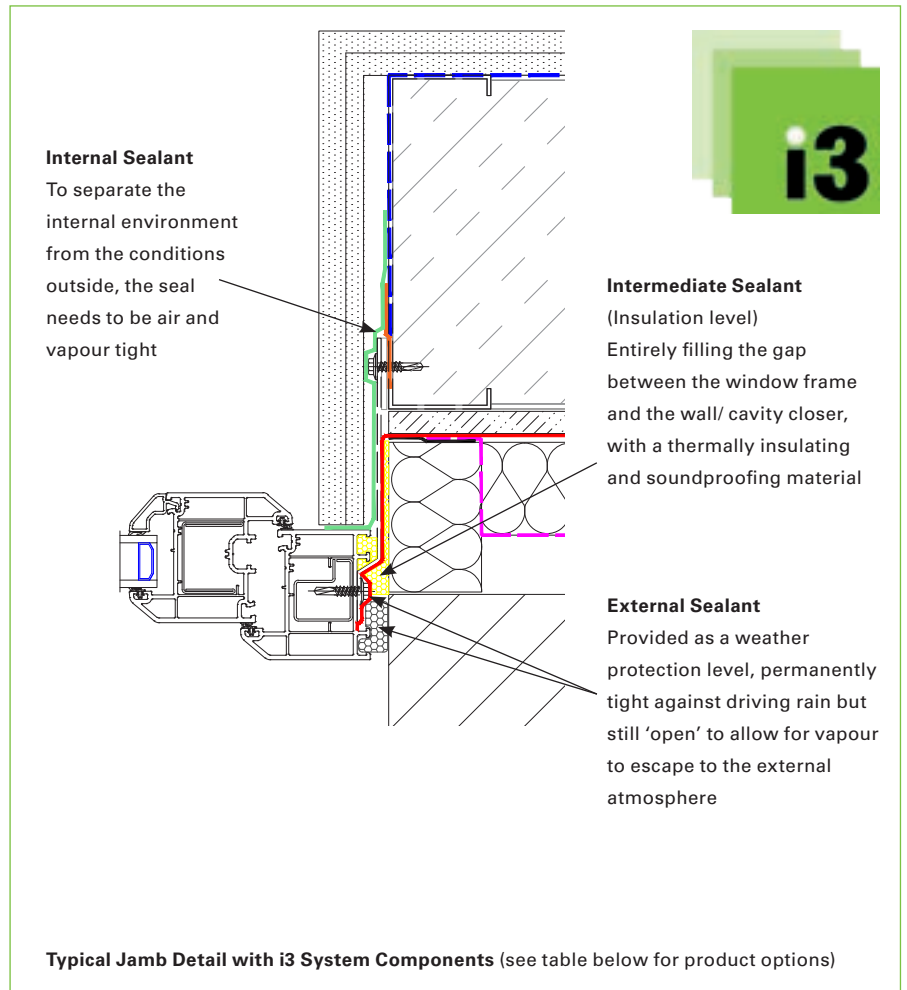

i3 System Options

External	Intermediate	Internal
TP450 TimberMax		ME500 Duo Flexible Window Membrane
TP600 Compriband 600		SP525 Frame & Façade Sealant & Adhesive
ME501 Duo Window Membrane HD	FM330 Pro Foam Air Seal	
ME508 Duo Membrane EW/F		ME508 Duo Membrane EW/F

Thermal Window Installation System

- Simplifies window installation
- Supports up to 200 kg/lm*
- Low through-life cost during service life of building**
- Enables internal installation of windows in hard to access areas
- Can be used as thermally efficient alternative sill support or full window installation system

SY001

Thermal Window Installation System



SY001 Thermal Window Installation System is a highly innovative system which facilitates the installation and perimeter sealing of windows into typical backing wall openings. The finished installation provides an airtight and weather-tight seal and also enhances the thermal properties of the window by avoiding thermal bridges such as those resulting from the use of metal dead-load support angles. Additionally, it also has a significant positive impact on achieving Fabric Energy Efficiency Standard (FEES) targets via SAP.

The SY001 profile options provide projections from the backing wall from 35 - 200 mm and can be mechanically fixed or bonded to SFS or solid type construction. Whilst the full system forms a complete surround to the window, removing the need for membranes, a single length of the appropriate profile can alternatively be used as a dead-load support. Once the SY001 is installed, windows can be sealed in a number of ways including using the illbruck i3 system or multi-function Trio tapes.

*@ 90 mm projection

** Based on a building service life of 60+ years

Product Benefits

- Significant thermal performance improvement
- Improved acoustic attenuation performance up to 49 dB
- Simplifies window installation – no need for complicated membrane installations
- Windows can be removed, replaced and resealed without removing the façade (4-sided only)
- High load capability – accommodates heavy windows/ doors with ease
- Suitable for use with solid wall, lightweight SFS or timber frame construction
- Enables early sealing of the weather-tight envelope
- Full system application ensures compatibility and proof of performance

Colours

Profiles – beige

Insulation - grey



System Options

PR011 Profile 35 mm projection

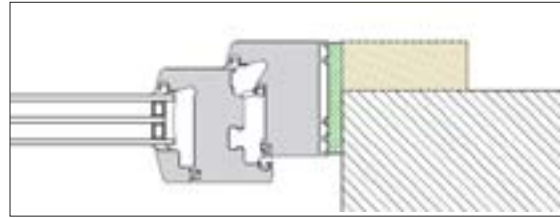

PR007 Profile 90 mm projection

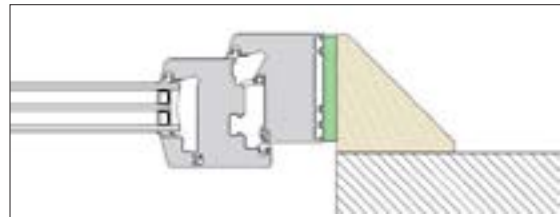

PR010 Profile 120-200 mm projection



SY001 Ancillary Products

AT140

Primer for
Porous Substrates



See Page 35

SP350

Fix & Seal
High Tack



See Page 35

PR008

Insulation
Profile



*Mechanical fixings are also required but
are not supplied by tremco illbruck*

Impregnated Foam Tapes

- Brand Leader - the original and proven to be the best performing tapes in the market
- Premium weather sealing
- 25+ years life expectancy
- 20+ years real life testing
- Guaranteed UV stability
- Wide range of sizes for joint widths of 2 to 50 mm

TP600

Compriband 600



TP600 is an open-cell, flexible polyurethane foam sealant, impregnated with a flame retardant acrylic resin, providing a high performance weather seal. It is pre-compressed and ready for use with a self-adhesive backing to aid location. After positioning, the material expands to create a permanent elastic seal. It remains flexible throughout its life and responds to the expansion/contraction cycles caused by thermal and structural movement.

TP600 is designed for use in a wide variety of movement joints including window perimeter seals and other applications.

Product Benefits

- 15 year performance guarantee
- Weather seal for wind-driven rain
- Moisture vapour permeable
- Continually expands and contracts to accommodate movement whilst still sealing the joints
- Thermal and acoustic insulation

Colours

Anthracite and grey (available on request).

Joint / Gap Size to be Filled mm	Joint Depth / Tape Width mm	Tape Order Reference	Roll Length (m)
2	10	10 / 2	12.5
3	10	10 / 3	10
3	20	20 / 3	10
3 - 7	10	10 / 3-7	8
3 - 7	15	15 / 3-7	8
3 - 7	20	20 / 3-7	8
5 - 10	10	10 / 5-10	5.6
5 - 10	15	15 / 5-10	5.6
5 - 10	20	20 / 5-10	5.6
7 - 12	15	15 / 7-12	4.3
7 - 12	20	20 / 7-12	4.3
7 - 12	25	25 / 7-12	4.3
8 - 15	15	15 / 8-15	3.3
8 - 15	20	20 / 8-15	3.3
8 - 15	30	30 / 8-15	3.3
10 - 18	20	20 / 10-18	4.5
10 - 18	25	25 / 10-18	4.5
10 - 18	30	30 / 10-18	4.5
13 - 24	20	20 / 13-24	5.2
13 - 24	25	25 / 13-24	5.2
13 - 24	30	30 / 13-24	5.2
17 - 32	30	30 / 17-32	4
17 - 32	35	35 / 17-32	4
28 - 40	40	40 / 28-40	2.7

- The tape should be selected so that the roll width (joint depth) is at least equal to the tape thickness (joint width) in service.
- For applications outside of this instruction, please consult our sales office.

TP450

**Compriband
Timber Max**



TP450 is a soft and flexible open cell polyurethane foam, impregnated with an acrylic based, UV stabilised resin. The resin is water repellent and contains a fire retardant. TP450 has a self-adhesive side to aid initial location and is easy to apply in any weather. Additionally, TP450 has both thermal and acoustic insulation properties. TP450 is designed for use in a wide variety of movement joints up to 50 mm wide and can accommodate up to 37 mm of movement. Weather tight against the most severe combinations of wind and rain, it satisfies most expectations as an external weather seal in building and civil engineering applications, with particular suitability for sealing the head and sills of windows installed in timber frame construction. Extensively tested, TP450 has a proven reputation across both the UK and Europe.

Product Benefits

- Accommodates up to 37 mm of joint movement within a maximum 50 mm wide gap
- Weather seal for wind-driven rain but vapour permeable to allow for drying out
- Can accommodate differential movement on timber frame construction up to 5 storeys

- Seals effectively – no remedial visits or wet sealants
- Continually expands and contracts to accommodate movement whilst still sealing the joints

Colours

Anthracite

Size	Joint Width (mm)	Tape Width (mm)	Roll Length (m)
14 / 4 - 10	4 - 10	14	5.8
15 / 5-15	5 - 15	15	4.5
25 / 10-24	10 - 24	25	7.0
40 / 13 - 40	13 - 40	40	5.2
50 / 13 - 50	13 - 50	50	5.2

NOTE: Larger sizes are UV stable up to 30 mm. Always use in line with illbruck best practice.

TP601

Compriband e



TP601 is a weather-retardant, impregnated, open cell, polyurethane soft foam, enclosed before use in a polypropylene film with a bonding adhesive on one side for fixing.

The tape is intended for the external, recessed perimeter sealing of windows and doors. The tear-off, encapsulating film permits the post-installation expansion of the foam strip, thus ensuring an effective weather seal.

Product Benefits

- Same high performance characteristics as TP600
- Factory or site application with activation at any time
- 600 Pa weather resistance
- Applied before frame installation
- No hazardous waste or clean up

Colours

Foam sealing tape – black (grey available if required)
Encapsulating film – clear
Adhesive release film – red

Nominal Joint Width (mm)	Maximum Joint Width (mm)	Metres / Carton
3	7	50
3	7	200
5	10	50
5	10	200
7	12	50
7	12	100

Tape width = 17 mm

Tapes: Multi-Functional

TP652 LL

Trio+ Linerless

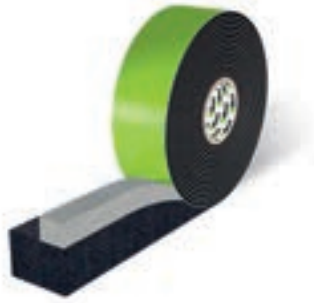

TP652 LL is a soft and flexible open cell polyurethane foam, impregnated with an acrylic based, flame retardent resin. It is supplied as pre-compressed rolls with a linerless self-adhesive side for easy roll-on application to aid initial location.

TP652 LL is used to seal window and door connecting joints against wind and driving rain while providing thermal and acoustic insulation for the entire installation depth. With the innovative interior step profile, a higher compression and airtightness is achieved to the internal face of the tape which fulfils the requirements for Passive House, other new-build and renovation.

It is the perfect sealing solution to SY001 Thermal Window Installation System.

Product Benefits

- Large number of multi-functional uses (from Passive Houses to refurbishment projects)
- Approximately 80% time savings during assembly because one product is used for inner, intermediate and outer sealing
- Resistant to driving rain, thermally insulated and airtight
- Emission-free, suitable for indoor use (emission test in

accordance with the AgBB/DIBt method)

- Modern management of dampness and vapour control

Colours

Anthracite and grey (step band)

Tape Size	Joint depth (tape width – mm)*	Joint width (tape thickness range – mm)
XS	66, 77, 88	4 - 7
S	66, 77, 88	6 - 10
M	66, 77, 88	8 - 15
L	66, 77, 88	10 - 20
XL	66, 77, 88	15 - 30

*The joint depth should be deeper than the tape width to allow a minimum 2 mm set-back from each face

For Domestic Applications

TP651

Trio Impregnated Tape

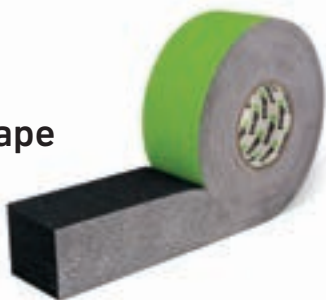

TP651 is an impregnated, pre-compressed multi-functional sealing tape. It is used for sealing the joints of windows and doors against driving rain and provides airtightness. It also offers thermally insulating properties within the perimeter gap between window and reveal and maintains the energy rating of the window/door.

Product Benefits

- Maintains the energy rating of the window
- Resistance to driving rain (600 Pa minimum), provides thermal and acoustic insulation and airtightness all in one product
- Quick and easy window

sealing in one application

- All-weather installation
- Vapour permeable
- Meets the requirements of RAL-quality-assured installation

Colours

Anthracite. Internal face: powder coated, light grey

Joint Depth (tape width) - mm	Joint Width (tape thickness range) (mm)	Roll Length (m)
35	3 - 7	15.0
35	5 - 10	10.0
35	7 - 15	6.0

66 mm wide option available (TP650) - please contact sales office for details

Intelligent Membranes

- 600 Pa weather and airtightness
- Variable vapour permeability
- Multiple installation methods to suit design and application requirements



ME508

Duo Membrane EW/F



i3

FIRST CHOICE FOR INTERNAL AIRTIGHTNESS

ME508 is a non-woven fleece laminate which is self adhesive across the full width of the membrane for optimised adhesion and vapour control. The combination of self-adhesive strips provide options for installing to the window frame edge (W) or face (E), providing air and weather tightness. Part of the intelligent membrane range, ME508 also benefits from humidity variable vapour permeability. ME508 is used for sealing window connection joints, particularly where wet plaster will be applied. Its strong and reliable self-adhesive strip allows bonding to virtually any substrate (e.g. masonry, concrete, PVC, metal, wood, and all usual insulation materials (EPS, XPS, PUR rigid foam)), making application fast and simple. ME508 can be used internally as an airtight seal or both internally and externally, providing minimum 600 Pa weather resistance.

Product Benefits

- Quick and easy application with split release liner
- Suitable for retrofit
- Initial repositioning possible, bond strength increases over time
- Airtight (to Passive House standards) and vapour tight
- No loose membrane, can be directly plastered over without cracking
- Weather tight to 600 Pa
- Up to 4 months UV stability
- 10 year performance guarantee as part of the i3 system
- Permeable – for vapour diffusion

Colour

Black

Roll Length	Roll Width	Rolls/Box
25 m	EW-70*	4
25 m	EW-100*	3
25 m	EW-140	2
25 m	EW-200	1
25 m	EW-250	1

Membrane thickness: 0.5 mm

Other sizes available upon request, subject to minimum order quantity/ value and lead time.

* Coming soon - 75 m dispensing box

ME501

Duo Window Membrane HD



FIRST CHOICE FOR WEATHER SEALING

PROJECTING WINDOWS - ME501 is a high strength, tear resistant intelligent membrane made from polyethylene copolymer film with non-woven fabric. It can be applied before or after window installation to suit on-site details and programming. It is also available with gasket and super-acrylic self-adhesive strip options for fixing to profile. The product meets the recommendations of the RAL Quality Assurance Association for windows and doors. Successfully tested by MPA Hannover to EN1026 (airtightness) & EN1027 (weather tightness). The membrane is attached to the window with SP525 adhesive or gasket and to the construction reveal material with SP525 adhesive, super-acrylic self adhesive or gasket.

ME501 provides a high performance seal to the perimeter joint between the window/curtain wall and the construction reveal. Due to the variable sd-value, the membrane is suitable for interior and exterior use and can provide an airtight or weather-tight (but permeable) seal.

Product Benefits

- Wide range of alternative adhesives allow the membrane to be bonded to virtually any common building substrate
- Complies with principle of 'inside tighter than outside' in order to facilitate efficient vapour control
- Excellent drying potential (due to the membrane's permeability) avoiding mould growth and physical damage
- Significantly reduces condensation risk in high performance built-up walls
- 12 months UV stability
- Variable sd - automatically

acts as a vapour barrier or breather membrane depending on location in wall construction

- Difficult to puncture and tear resistant - easy to repair

Packaging

- Supplied on 25 m rolls slit to width: min. 60 mm – max. 1500 mm.
- Length Tolerances to DIN 7715 P3.
- Width dimensions to tolerance ± 2.5 mm.

Colour

Black

Gasket Options

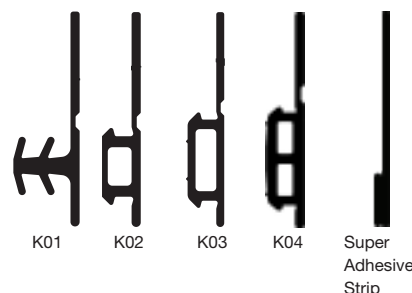

ME500

Duo Flexible Window Membrane



ME500 is an intelligent membrane providing perimeter window seals for airtight internal & weather-tight external joints. ME500 Duo Flexible Window Membranes (versions E & W) comprises a tear-proof non-woven fleece fabric with a polyethylene co-polymer film. An integrated movement pleat is included in the membrane which complies with the planning and installation recommendations of DIN 4108-7 and with the RAL Quality Assurance Association for windows and doors. It is attached to the wall with butyl adhesive, and to the window /door with a self-adhesive strip or an integral gasket. The product has a specially designed reactive membrane. The water vapour permeability (sd-value) changes depending on the humidity inside the joint. This allows the product to perform as an intelligent seal for

airtight internal joints, and weather-tight, permeable external joints. The intelligent reactive system ensures that the joint always dries at the maximum rate. In non-fenestration applications, the membrane can be used to seal across adjacent insulated panels as an airtight or weather-tight seal.

Product Benefits

- 10 year performance guarantee as part of the i3 system
- Weather seal for wind-driven rain
- Permeable – for vapour diffusion
- Airtight to Passive House standards

Colour

Grey

Width (mm)	Rolls per Carton	Metres per Carton
E 80-110	5	250
E 110-140	3	150
E 140-170	2	100
E 220-250	1	50
W 60-80	6	300
W 80-110	5	250
W 110-140	3	150
W 220-250	1	50

ME241

EPDM Corner



ME241 EPDM Corners are 3D corners moulded from EPDM for use in conjunction with illbruck membranes. They provide a high performance seal for the corners of the perimeter joint between the window/curtain wall and the backing wall, especially for projecting windows. The linear membranes to the perimeter of the window can be sealed in a robust manner, avoiding the complexity of multiple cutting and folding of the membranes. Suitable for use in conjunction with illbruck ME220 EPDM and ME501 Duo Window Membrane HD.

Product Benefits

- Strong pre-formed moulded rubber reinforcing the corner detail
- Reduced risk of tearing of EPDM membrane
- Waterproof - zero leakage
- Airtight - no second membrane required
- Easy to use due to 3D shape formation of the corner
- Safe sealing of critical corner joints
- Single adhesive bond - no requirement for primers
- Avoids cutting and folding of membranes

- Compatible with illbruck ME220 & ME501 Membranes
- UV stable – for the service life of the attached membranes

Dimensions

100 x 100 mm (flanges) x 95 mm (projection)

Colour

Black

ME541

Duo HD Prefab Corner



ME541 Duo HD Prefab Corner provides a high performance seal for the corners of the perimeter joint between the window/curtain wall and the construction reveal, especially for projecting windows.

Due to the variable sd-value, the prefab corner is suitable for interior and exterior use and can provide an airtight or weather-tight (but vapour permeable) seal.

Product Benefits

- Easy to use due to 3D shape formation of the corner
- Safe sealing of critical corner joints
- 12 months UV stability

Packaging

ME541 Duo HD prefab corner is supplied with 500 corners per box.

Colour

Black

AB004

Membrane Seam Rollers



See Page 39

AB005

Membrane Shears



See Page 39

AA976

Sausage Gun 600 Ultra Combi



See Page 38

EPDM & Butyl Membranes

- Watertight
- Airtight
- Suitable for permanent exposure

ME220

EPDM Membrane



ME220 is an EPDM-based membrane used for sealing interfaces to provide airtight or weather-tight seals. The material does not contain any solvents which could later migrate into adjacent surfaces.

Product Benefits

- High resistance to mechanical damage
- Excellent movement capability in both transverse and longitudinal direction with excellent material recovery after elongation
- Excellent weathering, ageing and UV radiation resistance
- Excellent vapour barrier

Packaging

Membrane with embossed finish, wound on rolls and available in various widths. The membrane is available in different formats to suit required fixing method:

- Slit to required width and fixed with proprietary illbruck contact or paste adhesives.
- As above but with choice of gasket to locate to window/curtain walling frames.
- With acrylic and butyl self-adhesive strips for fixing to frame and construction substrate.*

* Available in 100 - 300 mm widths in 50 mm increments subject to product availability.

Roll length: 20 m (1st option above) or 25 m (2nd & 3rd options above)

Thickness 0.7 - 0.75 mm⁺

Width 50 - 1,500 mm

⁺ 1.2 mm also available subject to minimum order quantity

Standard width tolerance for cut dimensions approximately 1 mm, thickness tolerance approximately 10%.

Colour

Black

Gasket Options

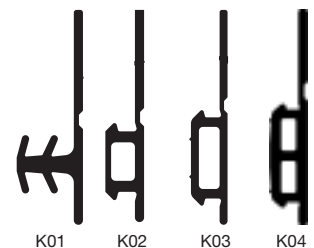

K01

K02

K03

K04

ME407

Butyl Tape NT



ME407 is a cold applied, self-adhesive membrane for vapour, air and watertight joints between exterior wall sections and load-bearing structures. Used to make various joints and exterior wall sections internally vapour and airtight, externally watertight, and to create pressure equalisation in the exterior wall structure.

Product Benefits

- UV resistant film/backing
- Bonds to virtually all existing substrates
- Does not require preheating before or during application
- Provides permanent grip

Priming

Certain substrates or ambient conditions may require the use of primer in order to achieve a satisfactory bond. ME901 and ME902 are recommended (see TDS for each product for further details).

Packaging

Roll Width (mm)	Roll Thickness (mm)	Rolls/Box
50	0.8	12
100	0.8	6
150	0.8	4
200	0.8	3
250	0.8	2
300	0.8	2
350	0.8	1

Roll length = 20 m

Colours

Black film, black butyl (grey also available)



Building Protection Range

- External weather-tight membranes
- Internal airtight membrane system
- System compatibility assured!

ME010

Breather Membrane UV + Fire



ME010 is a highly vapour open, hydrophobic polyester-based breather membrane that can be directly laid on sheathing board or thermal insulation behind partially or fully open rainscreen façades or curtain walling and has Euroclass B (s3, d0) fire classification to EN13501-1.

Product Benefits

- Permanently UV-resistant
- Euroclass B according to EN 13501-1 - fixed to thermal insulation and 'free-hanging'
- Highest range of in-service temperature resistance
- Highly vapour open

- Airtight and weather-tight
- Available with self-adhesive strip

Packaging

1.5 m wide x 50 m long roll

Colours

Black

ME011

Breather Membrane UV



ME011 is a special monolithic functional membrane. It can be directly laid on sheathing board or thermal insulation behind partially open rain screen façades or curtain walling with up to 30 mm wide open joints.

Product Benefits

- UV resistant – 6 months UV stable
- Can be used within partially open façades
- Non-branded, plain black finish - suitable for visible applications
- Wide range of in-service temperature resistance

- Highly vapour open
- Air-tight and weather-tight
- Available with self-adhesive strip

Packaging

1.5 m wide x 50 m long roll

Colours

Black

ME012

Duo Window Fire Membrane



ME012 Duo Window Fire Membrane is a polyester based waterproof and airtight but vapour permeable window perimeter sealing membrane with enhanced UV stabilisation and a Class B1 (not easily flammable) Classification under DIN 4102 and Class B (s3-d0) according to EN13501-1.

Product Benefits

- Fire resistant to Class B1 (DIN 4102) & B [s3-d0] (EN13501-1) - fixed to thermal insulation and 'free-hanging'
- Highly water tight – does not allow driving rain to pass from outside to inside
- Highly airtight to prevent unplanned air loss
- Complies with "inside tighter than outside" facilitating efficient vapour control
- Vapour permeable - excellent

drying potential of the perimeter joint avoiding mould growth and physical damage

- Permanently UV stable in open joints between cladding and window frame

Packaging

Supplied in slit widths 60 mm - 1500 mm on 50 m rolls.

Colours

Black

ME315

Total Protection Tape



ME315 is a single-sided adhesive tape for interior and exterior use, providing a high performing air and weather-tightness seal. Suitable for a wide variety of applications, including sealing of sheathing boards and the durable bonding of illbruck vapour barrier and breather membranes. A permanent bond is achieved on all tremco illbruck indoor and outdoor building protection membranes.

Product Benefits

- Interior and exterior use
- Quick and easy application
- Highly UV resistant
- Can be used within partially open façades
- Weather resistant
- Highly moisture resistant adhesive

Packaging

60 mm x 25 m (12 rolls/box)
100 mm x 25 mm (6 rolls/box)
150 mm x 25 mm (4 rolls/box)

Colours

Black

ME316

Endurance Tape



ME316 is a single-sided adhesive tape for interior and exterior use providing a high performing air and weather-tightness seal. Suitable for a wide variety of applications, including sealing of sheathing boards and for the durable bonding of illbruck commercial vapour barrier, and breather membranes. Particularly suited for sealing of joints between timber panels to maintain long-term performance. A permanent bond is achieved on all illbruck building protection membranes and PE, PA, PP, aluminium foils, concrete, brick and block, aerated concrete and wood used to create an airtight seal.

Product Benefits

- Interior and exterior use
- 6 month UV stability and outdoor exposure
- Can be used in partially open facades – low visibility branding when installed
- Quick and easy application
- Soft fleece backing
- Excellent permanent adhesive

bond strength to most common substrates

Packaging

60 mm wide x 25 m long (10 rolls per box)

Colours

Black

Membranes

ME003

Internal Vapour Membrane



ME003 is an innovative 3-ply co-extruded PE vapour barrier membrane which meets virtually all the demands of professional practice and protects the construction and insulation by providing a vapour and airtight seal.

Product Benefits

- Straightforward application due to low weight
- Flexible and tear-resistant
- Highly vapour retardant
- Compatible with illbruck intelligent window membranes and adhesives
- Comparable diffusion resistance properties to typical 160 µm PE vapour barriers, despite its lower thickness
- sd value of 107 m equivalent to 535 MNs/g

Packaging

1.5 m wide x 50 m long roll

Colour

Blue

ME317

Internal Membrane Tape



ME317 is a single-sided adhesive reinforced paper tape. For the airtight bonding of overlaps in illbruck vapour barrier and membranes for interior use. Also for joints in OSB boards and as an air-seal tape for penetrations.

Product Benefits

- Fully compatible with all internal illbruck building protection products
- Strong kraft paper
- Easy to tear off by hand
- Quick and easy application

Packaging

60 mm wide x 40 m long (8 rolls per box)

Colours

Yellow

Membrane Adhesives

OT301

Endurance Adhesive



See Page 22

SP525

Frame & Façade Sealant & Duo Membrane Adhesive



See Page 30

OT015

High Tack EPDM Membrane Adhesive



See Page 21

Adhesives

- Proven performance
- Cost effective
- User friendly

OT015

High Tack EPDM Membrane Adhesive



OT015 is a specially formulated high tack adhesive to bond ME220 and ME501 membranes.

Product Benefits

- Fast and easy application method
- Excellent weather and temperature resistance
- Excellent bond strength

- Excellent resistance to ageing
- Ideal for uneven substrates

Packaging

600 ml sausage (12/carton)

Colour

Black

OT008

Low Solvent EPDM Adhesive



OT008 Paste Adhesive is a special adhesive particularly suited for bonding ME220 onto solvent sensitive substrates.

Product Benefits

- Compatible with styrene and PUR boards

Packaging

600 ml sausage (12/carton)

Colour

Black

CT113

EPDM Membrane Adhesive



CT113 is a viscous contact adhesive based on synthetic rubber and resins.

Product Benefits

- Permanent bonding of EPDM membranes
- Rapid curing, high-grab formulation - cures in 20 minutes

- Excellent resistance to weather and UV
- Can be used with TREMCO AW421 to make an easy to apply EPDM primer

Packaging

5 litre / 4.7 kg pail

Colour

Black

Adhesives

OT301

Endurance Adhesive

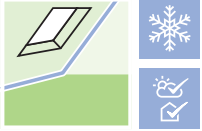

OT301 is an adhesive which is used, as part of the illbruck Building Protection Range, for creating airtight joints.

Product Benefits

- Very high, permanent adhesion
- Quick drying
- Very elastic, permanently flexible

Packaging

310 ml cartridge (20/carton)

Colour

Green

SP350

Fix & Seal High Tack

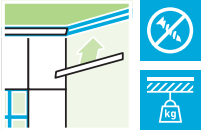

SP350 is a one component, non-sagging, elastic adhesive based on hybrid polymers. It is ideal for a vast range of interior & exterior applications and may be applied to damp substrates.

Product Benefits

- High grab
- Solvent free, low odour
- Good resistance to light, weather and ageing

Packaging

310 ml cartridge (12/carton)

Colour

White

Fabrication Adhesives

PU038

Corner Cleat Adhesive



PU038 is a solvent free, two component, polyurethane based adhesive that is mainly used for the structural bonding of corner angles of aluminum windows and doors. Bonded parts can be powder coated afterwards.

Product Benefits

- Solvent free
- Thixotropic - will not drip
- Good weather resistance
- Easy to apply

Packaging

900 g kits (6 kits per carton).

Colour

Resin: white-beige
Hardener: brown-beige
Cured film: beige

Fabrication Adhesive Accessories

AA821

2K Cartridge Gun 310 Airflow Combi



AA881

2K Cartridge Gun 310 Pro Combi



These high quality guns are extremely useful when working with high viscous adhesives such as PU038, 2 part PU adhesive.

For our complete range of guns, please refer to the illbruck Application Gun Range Brochure.

PU Foams

- High movement accommodation
- Excellent thermal insulation
- Acoustic attenuation up to 60 dB

FM330

Pro Foam Air Seal



FM330 is a rapid curing, highly elastic gun grade polyurethane foam. FM330 is ideal for use as an airtight gap filler for construction and window perimeter joints. It is also suitable for applications such as sealing floor to wall and wall to ceiling joints and pipe & service penetrations. The movement accommodation factor (MAF) of 50% ensures that the integrity of the seal is maintained in the event of movement and settlement.

Product Benefits

- A high performance PU foam with excellent acoustic and airtight performance
- Airtight formulation - tested to EN12114, <math><0.1 \text{ m}^3/\text{h.m}</math> at 1000 Pa (positive and negative pressure); $0.1 \text{ m}^3/\text{h.m}$ at 1250 Pa (positive pressure - separate test)
- Acoustic attenuation - up to 60 dB joint insulation
- Elastic performance - up to 50% movement accommodation ensures integrity of the seal in the event of movement
- Sub-zero formulation - can still be used at temperatures as low as -3°C
- Low post-expansion facilitates more accurate application depth
- Helps achieve UK Building Regulations Part L
- Bonds to most common building materials
- Applications include: roofs, walls and floors
- Airtight, thermal and acoustic insulation

Packaging

750 ml pressurised canister (12/carton)

Colour

White

Foams

FM365

B3 Expanding Foam Max



FM365 is a rapid curing, high yield, one component gun grade expanding polyurethane foam that is suitable for general gap filling, bonding and insulation applications. These include the perimeter sealing and fixing of windows and doors, sealing of service penetrations and sealing around insulation panels.

Product Benefits

- Ideal for filling, sealing and insulating of joints and gaps
- High yield application (when used with conical adaptor or straw)
- Rapid cure formulation
- Forms a strong bond to most common building materials

Packaging

540 ml pressurised canister (12/carton)

Colour

Green

FF197

Nullifire Fire-Rated PU Construction Foam



FF197 is a modified, single component, fire rated polyurethane foam that is used to seal linear gaps throughout the fire rated areas of a building.

Product Benefits

- FD60 approved under BS EN 1634-1
- Gaps up to 35 mm
- No architrave required
- Can be used with standard packers
- Tested to BS EN 1366-4, BS EN 1634-1 and meets BS476-20 & 22
- 2-in-1 gun & nozzle canister

Packaging

750 ml pressurised canister (12 per box)

Colour

Pink

Foam Accessories

AA270

Foam Gun Ultra



See Page 38

AA290

PU Solvent Cleaner



See Page 35

Sealants

- Innovative
- High levels of performance
- Excellent movement accommodation

FS500

Frame & Façade Silicone

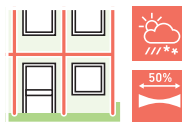

FS500 is a low modulus, neutral curing, silicone sealant with high movement capability. It has excellent adhesion to most porous and non-porous substrates including polycarbonate.

Product Benefits

- Meets the requirements of EN ISO 11600 G&F 25LM
- Movement capability: up to 50%
- Long-term resistance to weathering, ageing and UV
- Ideal for the solid bedding glazing method for timber windows

Packaging

310 ml cartridge (20/carton)
600 ml sausage (20/carton)

Colours

Black, white.
Anthracite (310 ml only).
Other colours on request — subject to availability and minimum order quantity.

FA600

Frame Silicone

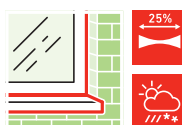

FA600 cures rapidly to form a permanently flexible and extremely durable watertight seal. It is designed for sealing: window & door perimeters, windows, display cases, etc., as well as conservatories & greenhouses.

Product Benefits

- Meets the requirements of ISO 11600-F&G-25LM
- Long-term resistance to weathering, ageing and UV
- Wide Service Temperature Range: -40°C to +140°C

600 ml sausages (20/carton)
subject to minimum order quantities.

Colours

Translucent, white, brown, grey and black.
Other colours - subject to availability/minimum order quantity.

Packaging

310 ml cartridge (20/carton)

FA870

Premium Natural Stone Silicone



FA870 is a non-staining, neutral curing silicone sealant. It provides long term elastic sealing of connection and movement joints between natural stones such as granite, slate, terrazzo, porphyry, limestone, travertine, sandstone, quartzite, marble, etc. as well as for connection joints with other conventional materials like concrete, ceramics, metals, glass, PVC and primed wood.

Product Benefits

- A high performance silicone sealant developed specifically for the sealing of natural stone whereby illbruck guarantees no migratory staining
- Long-term resistance to weathering, ageing and UV
- Contains fungicide to prevent mould growth
- Chemically neutral, non-corrosive and very low odour
- Rapid curing formulation - skins within 10- 20 minutes

Packaging

310 ml cartridges (20/carton)

600 ml sausages (20/carton)

Colours*

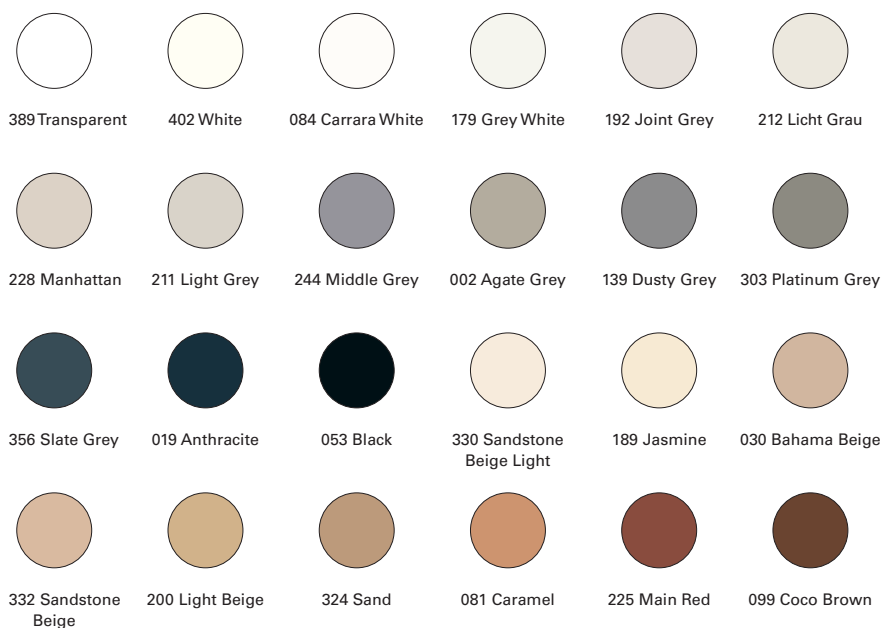

* Colour swatches are indicative only.
For colour samples, please contact our
Sales Office on +44 (0)1942 251400.

FA880

Premium Natural Stone Silicone Matt



FA880 has been formulated for the long term elastic sealing of movement joints between natural stone such as granite, slate, terrazzo, porphyry, limestone, travertine, sandstone, quartzite, marble, etc., as well as for joints with other construction materials like concrete, ceramics, metals, glass, PVC and primed wood.

Product Benefits

- A high performance silicone sealant developed specifically for the sealing of natural stone whereby illbruck guarantees no migratory staining
- Superb matt finish
- Good resistance to UV light, ageing and weathering
- Contains fungicide to prevent mould growth- suitable for sanitary & swimming pool surround applications
- Rapid curing formulation- skins within 10- 20 minutes
- Chemically neutral, non-corrosive and very low odour
- Compatible with most construction materials

Packaging

310 ml cartridges (12/carton)

Colours*



* Colour swatches are indicative only.
For colour samples, please contact our
Sales Office on +44 (0)1942 251400.

Silicone Sealants

FS125

Premium Frame & Façade Silicone

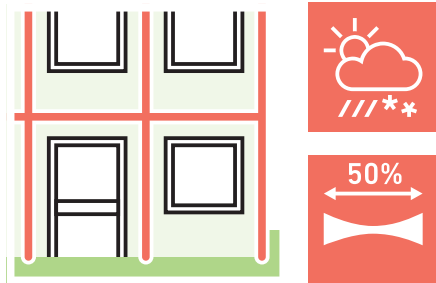

FS125 is a one-part, neutral curing, low modulus, low odour silicone sealant suitable for perimeter joint sealing applications with high movement capability. It has excellent primerless adhesion to multiple surfaces including masonry, brick, aluminium, PVC-U, polycarbonate, polyacrylate, wood, painted wood, glass and glazed surfaces.

Product Benefits

- Meets the requirements of EN ISO 11600 G&F 25LM
- Movement capability: up to 50%
- Long-term resistance to weathering, ageing and extra UV protection
- Low modulus formulation ensures minimum stress at joint faces
- Neutral cure: low odour and non-corrosive
- Modern colour range in low sheen finish
- Easy to tool into place and smooth off

Packaging

310 ml cartridges (20/carton)

Colours*



* Colour swatches are indicative only.
For colour samples, please contact our
Sales Office on +44 (0)1942 251400.

Sealant Accessories

AA301

Smoothing
Agent



See Page 39

AA311

Jointing
Tools



See Page 39

AA874

Cartridge Gun
400 Ultra



See Page 38

SP510

Low Mod Construction Sealant

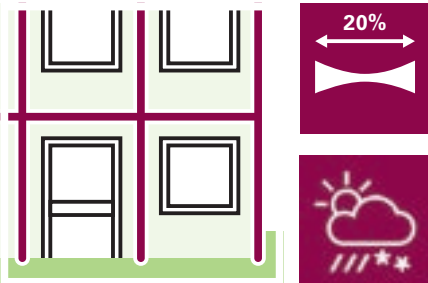

SP510 is a low modulus sealant and is low slump even in warmer temperatures. It has excellent application properties. It cures with air humidity, to form a tack-free surface and provides good resistance to light, ageing and weathering. SP510 is suitable for long term elastic sealing of window and door perimeter joints and movement joints between construction components. It can be used for indoor* and outdoor applications. It is compatible with metals and most construction materials.

*excluding bathrooms/sanitary areas

Product Benefits

- Easy to tool
- Free from isocyanates, silicone & solvents
- Low slump
- Can be painted over
- Easy to tool into place and smooth off

Packaging

310 ml cartridge (12 per carton), 400 ml sausage (20 per carton), 600 ml sausage (20 per carton)

Colours*



White



Brown



Ivory



Anthracite



Black



Grey



* Colour swatches are indicative only. For colour samples, please contact our Sales Office on +44 (0)1942 251400.

SP925

Air Seal



SP925 is a one-component, low-viscosity sealant based on hybrid polymer technologies. It is chemically neutral, low odour and is compatible with most common building substrates.

Product Benefits

- Easy sealing of complex small joints
- Very easy to handle
- Brushable and sprayable
- Permanently elastic
- Fast curing
- Solvent, isocyanate and silicone free
- Can be applied to damp substrates

Packaging

600 ml sausage (20/carton)

Colours

Anthracite

Hybrid Sealants

SP525

Frame & Façade Sealant & Duo Membrane Adhesive

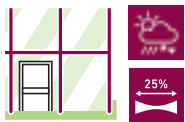

SP525 is a low modulus sealant and adhesive formulated using advanced SP polymer technology. It has high movement capability, excellent primerless adhesion and long-term performance. Ideal for: façade joints, rainscreens & curtain walls, perimeter joints around windows, doors & rooflights and high movement joints (eg. modular building).

Product Benefits

- Meets the requirements of EN ISO 11600 F 25LM
- Formulation based on advanced SP polymer technology
- High movement, rapid curing and non-staining formulation
- Excellent long-term resistance to weathering, ageing and UV
- Low modulus formulation ensures minimum strain at joint faces

- Suitable as an adhesive for ME500 or ME501 intelligent membranes

Packaging

600 ml sausages (20/carton)

Colours

402 White, 278 Oyster White, 105 Concrete Grey, 211 Light Grey, 237 Medium Grey, 019 Anthracite, 053 Black, 332 Sandstone Beige, 219 Light Sandstone Beige and 077 Buff.

Bituminous Sealants

OS111

Bituminous Sealant

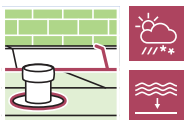

OS111 is a high performance, bituminous sealant and adhesive that can be applied on damp or wet substrates. It is ideal for sealing leaks and making repairs, even on wet surfaces.

Product Benefits

- Can be applied to damp or wet substrates
- Excellent adhesion to a wide range of materials
- Long-term resistance to weathering, ageing and UV
- Bonds ME501 to bituminous substrates

Packaging

310 ml cartridge (24/carton)

Colour

Black

SHELL

Tixophalte Wet Seal & Fix



A professional bituminous adhesive and sealant with permanent flexibility giving superior adhesion, even under wet conditions. Has long-term resistance to weathering, ageing and UV and is the ideal solution where silicones, PUs, acrylics, hybrids, etc., cannot be used.

Product Benefits

- Ready-to-use, easy to apply
- Can be applied in wet conditions and even under water
- Good adhesion to most surfaces
- Can be used with asphalt, concrete, cement, brick, metal, glass & plastic

Packaging

310 ml cartridge (12 per case), 600 ml sausage (20 per case)

Colour

Black

FS702

Nullifire Intumescent Acrylic Sealant



Nullifire FS702 cures to give a firm but flexible fire seal whilst providing an excellent acoustic and air seal. It is ideally suited for use around small annular service penetration seals in walls and floors.

Product Benefits

- Can achieve up to 4 hours joint fire resistance tested in accordance with EN 1366-4 and ETAG 026
- Ideal for sealing low movement joints - suitable for gaps up to 50 mm wide
- Suitable for rigid and flexible walls
- Used for sealing FB750 Coated Batts
- Acoustics up to 61 dB
- Air seal up to 2,000 Pa
- Single sided seal tested
- Easily paintable

Packaging

310 ml cartridge (12/carton)
600 ml sausage (12/carton)

Colour

White and grey

FS703

Nullifire Fire Resistant Silicone Sealant



Nullifire FS703 provides a fire resistant seal for high movement joints. For internal use in: joints in compartment walls and floors, seals in and around lightweight partitioning, gaps between frames and structures, bedding of fire door locks and hinges, around pipes and services, and at junctions of different materials.

Product Benefits

- Can achieve up to 5 hours joint fire resistance tested in accordance with EN 1366-4
- Suitable for gaps up to 50 mm wide
- Excellent unprimed adhesion
- Slump free with a long service life
- Seal ratio at 2:1 (e.g. 10 mm width x 5 mm depth)

Packaging

310 ml cartridge (12/carton)
600 ml sausage (12/carton)

Colours

White and grey

FS709

Nullifire Graphite-Based Intumescent Sealant



Nullifire FS709 is a single part, graphite based, fire resistant intumescent sealant. It is designed to close off gaps and penetrations in compartment walls and floors, to provide up to 4 hours fire resistance. This product has been formulated to close off plastic pipe penetrations in the event of a fire, negating the need for pipe closers or wrap systems.

Product Benefits

- Certified to the latest European standards EN 1366-3 and EN1366-4, Classified to EN 13501-2:2007
- Up to 240 minutes fire resistance
- A+ internal air quality rating
- Can be used in FB750 Batt
- Tested with combustible pipes up to 125 mm
- Tested for use in linear gaps up to 25 mm
- Tested with metallic pipes, cables, cable bunches, cable trays and cable ladders

Packaging

310 ml cartridge (12/carton)

Colour

Grey

Pressure Sensitive Adhesive Tapes

- High bond strength
- Innovative products
- Wide range of applications
- Standard and bespoke sizes

TN021

Foamed Acrylic Tape



TN021 is a foamed acrylic tape with very high shear and peel performance. Offers excellent load bearing capabilities and weathering resistance. Ideal for bonding glass, metals, ceramics and most plastics in demanding environments.

Product Benefits

- In most cases, TN021 tapes are capable of replacing rivets, spot welds, liquid adhesives and other permanent fasteners
- Non-mechanical bonding – can support reduction in gauge thickness
- Achieves a constant, factory-controlled bond film thickness

Packaging

Boxed quantities variable dependent on size. Contact tremco illbruck Customer Service Department for details.

TN150

High Performance Bonding Tape



TN150 is a high-performance, double-sided bonding tape used for permanent mounting of signage, fixtures and panels, glazing bars, and industrial fabrication/assembly applications.

Product Benefits

- High tack pressure sensitive adhesive gives high instant grab and a strong permanent bond
- A non-invasive alternative to mechanical fixings, avoiding penetration or damage of mounting surfaces
- Quick and efficient to use – no odour, no drilling, no mixing, no waste

Packaging

Thickness: 1 and 2 mm Width: 6 to 1,050 mm
Any width within the range noted above can be cut subject to minimum order quantities. Stock sizes are available and our Customer Services team can supply details as well as advise on cut to order sizes, minimum order quantities and lead time.

TN563

Sealing Tape P235



TN563 is a PVC foam tape which can be used either uncompressed (as an acoustic or dust seal), or at 30% compression (as an air or weather seal).

Product Benefits

- Excellent insulation performance against shock, vibration and movement
- When under compression (30%), provides an effective weather seal against wind and rain
- Provides a barrier to thermal bridging, galvanic corrosion and acoustic transmission

Packaging

Thickness: 2, 3, 4, 5, 6, 8 and 10 mm
Width: 6 to 960 mm
Any width within the range noted above can be cut subject to minimum order quantities. Stock sizes are available and our Customer Services team can supply details as well as advise on cut to order sizes, minimum order quantities and lead time.

TN573

Sealing Tape P275



TN573 is a 1 mm thick PVC foam tape which can be used in narrow gap widths, to provide an effective weather seal even with only a low level of compression.

Product Benefits

- Excellent insulation performance against shock, vibration and movement
- Provides an effective weather seal against wind and rain, even under minimal levels of compression
- Provides a barrier to thermal bridging, galvanic corrosion and acoustic transmission

Packaging

Thickness: 1 mm
Width: 6 to 960 mm
Any width within the range noted above can be cut subject to minimum order quantities. Stock sizes are available and our Customer Services team can supply details as well as advise on cut to order sizes, minimum order quantities and lead time.

SG635

TREMCO Structural Glazing Spacer Tape



SG635 is a 300 kg/m³ density PVC foam which is designed to give a specific gap thickness for structural silicone in structural glazing systems. The open cell nature of the foam allows curing of structural silicones.

Product Benefits

- Compatible with structural silicone adhesives (tested and approved by major manufacturers)
- High shore hardness giving guaranteed joint thickness
- Low thermal conductivity
- Available in a range of widths and thicknesses to suit a range of structural systems
- Fast recovery from compression

Packaging

Packed in multiple rolls in boxes with silicone interleaves in sizes: 3 mm, 4 mm, 5 mm and 6 mm thickness available in any width from 6 mm up to 980 mm.
8 mm, 9.5 mm, and 12 mm from 8 mm up to 980 mm widths.

Protection Tapes

AW400

Glass Protection Film



AW400 Glass Protection Film is a self-adhesive film suitable for application to glass and other surfaces requiring temporary protection against damage during processing and storage or resulting from other trades activity once installed. The film can be applied to glass, rough painted metals and rough plastic surfaces.

Benefits

- Protects glass from mortar, render or paint splatter
- Protects window and door profiles and fabricated components
- Translucent finish maximises light transmittance
- Easy application
- Easy removal
- 6 months UV resistance

Packaging

600 mm wide x 250 m long roll

Colours

Translucent blue and clear

AW401

Frame Protection Tape



AW401 Frame Protection Tape is a self-adhesive tape suitable for the protection of sensitive surfaces against dirt and damage during processing, transport, storage and installation. Typical substrates suitable for protection include painted metal (PVDF, polyester), plastic sheets (PVC, PC, melamine). It is particularly suitable for protecting window and door frames.

Benefits

- Protects sensitive surfaces from dirt, scratching, spillage
- Easy application
- Easy removal
- 6 months UV resistance

Packaging

Supplied in 100 m length rolls. Various roll widths are available.

Colours

Black inside / white outside

AW405

Protection Tape

AW405 is a single sided black low-tack protection tape. This thicker film offers a greater level of protection on hard to bond surfaces such as aluminium, steel and powder coated metals. Designed for use with high value items or where risk of scratching is high.

Benefits

- Easy to apply
- Provides excellent temporary protection to finished wood, aluminium, steel and powder coated surfaces

Packaging

Supplied in 100 m length rolls. Various roll widths are available.

Colours

Black

Accessories

- Cleaners
- Primers
- Guns
- Tools

AA290

PU Solvent Cleaner



Dual-purpose aerosol solvent based cleaner used to purge applicator guns and clean nozzles after PU foam applications. The spray nozzle adaptor can also be used to remove uncured PU foam from surfaces not affected by solvent.

Benefits

- High power cleaner for illbruck PU foams
- Fits most PU foam guns
- Dual-purpose cleaner/ aerosol

Packaging

500 ml (12/carton)

Colours

Clear

AW403

Industrial Glass Cleaner



Fast evaporating solvent solution removes dirt from glass surfaces to leave a sparkling finish. Effectively cleans all types of glass, mirrors and tiles.

Benefits

- Powerful industrial cleaner for glass, mirrors and tiles
- Cleans to leave a sparkling crystal clear finish
- Suitable for windows, mirrors, tiles and certain metals

Packaging

1 litre (12/carton)

Colours

Colourless

AW414

Mild Cleaner



AW414 is for cleaning coated glass, plastic and painted substrates where more aggressive products are unsuitable.

Benefits

- Mild cleaning solvent compatible with many sealants and primers

Packaging

2.5 litre tin

Colours

Colourless

Cleaners & Primers

AT115

Cleaner for Plastics



AT115 is ideal for cleaning and degreasing sensitive surfaces such as plastics, painted and powder-coated components as well as metals. Can also be used for cleaning tools and equipment.

Benefits

- Rapid drying and easy to use
- Ideal for cleaning sensitive substrates prior to the application of illbruck sealants

Packaging

1 litre tin (10 per box)

Colours

Transparent

AT200

General Purpose Cleaner for Degreasing Metals



AT200 is a blend of solvents for cleaning and degreasing joint edges and adhesive surfaces and for cleaning working tools.

Benefits

- Rapid drying and easy to use
- Ideal for cleaning substrates prior to the application of illbruck sealants

Packaging

500 ml (10/carton)
5 litre cans

Colours

Transparent

AW421

TREMCO Industrial Cleaner



TREMCO AW421 is a powerful solvent-based cleaning solution for dissolving and removing mastics, adhesives and sealants. It will remove many common adhesives and sealants, particularly in the uncured state. The product may also be used for cleaning and to degrease other surfaces that are not sensitive to solvents such as metal, ceramics and glass.

The product can also be used to dilute illbruck CT113 Contact Adhesive, in order to achieve a consistency suitable for use as a surface primer.

Packaging

5 litre screw top can

Colour

Clear

AT140

Primer for Porous Substrates



AT140 is used to give enhanced adhesion in cases of substandard substrates, or where significant movement is anticipated.

Benefits

- Provides enhanced adhesion of illbruck hybrid sealants and adhesives
- Rapid drying and easy to use

Packaging

500 ml (12/carton)
5 litre tins

Colours

Transparent

AT150

Primer for Non-Porous Substrates



AT150 is used to give enhanced adhesion in cases of substandard substrates, or where significant movement is anticipated.

Benefits

- Provides enhanced adhesion of illbruck hybrid sealants and adhesives
- Rapid drying and easy to use

Packaging

500 ml (12/carton)

Colours

Transparent

ME901

Butyl & Bitumen Primer



ME901 Butyl & Bitumen Primer is a brush applied polymer solution. It is used as a pre-treatment bonding agent and primer when working with illbruck butyl and bitumen tapes and membranes. Ideal for bonding ME315 and ME508 in external conditions.

Product Benefits

- Improves tape / membrane adhesion on cold or damp surfaces
- Stabilises unsound surfaces
- Improves weathersealing on porous substrates
- Quick drying

- Can be used down to -5°C

Packaging

1 litre (12 per carton) and 5 litre tins

Colours

Transparent

ME902

Butyl & Bitumen Spray Primer



ME902 is a spray applied polymer solution that serves as a bonding agent and primer for the application of illbruck membranes incorporating butyl and bitumen adhesives. Ideal for bonding ME508 in internal conditions.

Product Benefits

- Easy spray application
- Improves tape / membrane adhesion on cold or damp surfaces
- Stabilises unsound surfaces
- Improves weathersealing on porous substrates

- Quick drying

Packaging

500 ml aerosol can (12 per carton)

Colours

Transparent

ME904

Adhesive Tape Primer



ME904 is used for the pre-treatment of building substrates, e.g. cement particle board, masonry, timber, etc., when using illbruck building protection tapes, particularly for bonding to damp substrates. Ideal for bonding ME508 in internal conditions.

Product Benefits

- Optimises adhesion
- Stabilisation of the surface
- Short drying time
- Solvent free
- Allows use of illbruck building protection tapes in damp conditions

Packaging

1 litre tin

Colours

White on application, transparent after drying

Guns

AA854

Cartridge Gun 400 Pro



This high quality gun has an excellent combination of thrust and ratio; so, it is extremely useful when many linear metres per day need to be applied, for example with our SP525 façade sealant.

Packaging

Individual units

AA874

Cartridge Gun 400 Ultra



This extremely strong quality gun has an excellent thrust so it is extremely useful when you have to deal with highly viscous adhesives, for example with our SP350 high tack adhesive. Suitable for use with 310 - 400 ml cartridges.

Packaging

Individual units

AA956

Sausage Gun 600 Pro Combi



This high quality gun has an excellent combination of thrust and ratio; so, it is extremely useful when many linear metres per day need to be applied, for example with our SP525 façade sealant. Suitable for use with 310 - 400 ml cartridges and 400 - 600 ml sausages.

Packaging

Individual units

AA976

Sausage Gun 600 Ultra Combi



This extremely strong quality gun has an excellent thrust so it is extremely useful when you have to deal with highly viscous adhesives and sealants. Suitable for use with 310 - 400 ml cartridges and 400 - 600 ml sausages.

Packaging

Individual units

AA270

Foam Gun Ultra



This ultra-high quality gun has been specially designed for the professional end-user. The hybrid design, with metal and thermoplastic material parts is solvent and stick proof. A PTFE coating on metal parts makes cleaning and maintenance easier.

Packaging

Individual units

AA291

Multi-Purpose Lubricant Spray



AA291 Lubricant Spray is an aerosol applied Teflon based CFC, HFC and HCFC free non-staining lubricant for use on metal and plastic moving parts. It produces a dry, low friction, non-stick protective coating that is hard wearing and long lasting. AA291 is ideal for the maintenance of PU Foam guns.

Packaging

200 ml aerosol cans with spray nozzle (12 per carton)

AA292

Cleaning Wipes



AA292 is designed to clean wet and semi-cured paint, sealant, adhesives, bitumen, polyurethanes, expanding foams, polyester fillers and epoxies from hands, tools and surfaces.

Packaging

100 per tub (6 tubs per carton)

AB004

Membrane Seam Rollers



The most efficient way of getting maximum contact when applying illbruck membranes. This handy roller allows a professional finish eliminating air bubbles and wrinkles and allowing the product to be applied "right first time".

Packaging

Individual units

AB006

Tape Belts



Designed specifically to keep part rolls of illbruck tapes from expanding.

Packaging

2 pc set

AA301

Smoothing Agent



AA301 helps achieve a better finish on the sealant when tooling off. Just spray on the freshly gunned silicone and smooth off the sealant in the normal way with the smoothing tool. Far better than washing up liquid or common alternatives!

Packaging

750 ml spray bottle (12/carton)

AA400

Anti-Mould Spray



AA400 can be sprayed onto mould to remove it, and will also prevent further mould from forming for a significant amount of time. If mould persists, please contact tremco illbruck technical department.

Packaging

500 ml spray bottle (12/carton)

AB005

Membrane Shears



Get a perfect cut everytime on illbruck membranes. Designed to cut cleanly and efficiently with a lock to keep the shears closed when not in use. The perfect tool for the professional.

Packaging

Individual units

AB007

Tape Roll Clips



Designed to clip onto the end of cut impregnated foam expanding tape to stop further expansion and avoid wastage. Keeps the roll tidy and neat and ready for use next time.

Packaging

Individual units

AA311

Jointing Tools



AA311 is a tooling kit contained in a small box. Available in round or angular profiles, each box having 3 tools. They are made of high quality plastic to give an excellent finish.

Packaging

Round Profiles: 3 per box (6 different profiles 4 - 14 mm)
Angular Profiles: 3 per box (6 different profiles 3 - 10 mm)

Sealant Primer Selector

Substrate

Bricks, Concrete & Stone

Brick
Concrete
Natural Stone
Plaster

Metals

Aluminium
Aluminium Anodised
Aluminium Powder Coated
Brass
Copper
Galvanised Steel
Iron
Stainless Steel

Glass

Glass

Plastics

ABS
Acrylic Glass PMMA
Polyamide*
Polycarbonate*
Polyester GRP
PVC Rigid*
PVC Soft Sheet/Film*
Sanitary Acrylic*

Wood

Wood*
Wood Primed*
Wood Painted (acrylic)*
Wood Stained

Tiles

Glazed Tiles
Tiles Reverse Side
Unglazed Tiles

Others











Enamel

FA600	FA870	FA880	FS125	FS500	SP510	SP525
AT101	+, AT101	+, AT101	+, AT101	+, AT101	AT140	+, AT140
+, AT101	+, AT101	+, AT101	+, AT101	+, AT101	+, AT140	+, AT140
	+, AT101	+, AT101				
	AT101	AT101	AT101			
+	+	+	+	+	+	+
+	+, AT120	+, AT120	+, AT120	+, AT120	+	+
+, Test	+, Test	+, Test	+, Test	+, Test	Test	Test
	+, AT105, AT120	+, AT105, AT120	+		+	AT150
	+, AT105, AT120	+, AT105, AT120	+		+	AT150
+, AT105, AT120	+, AT105, AT120	+, AT105, AT120	+, AT105, AT120	+, AT105, AT120	+	AT150
+, AT105, AT120	+, AT105, AT120	+, AT105, AT120	+, AT105, AT120	+, AT105, AT120	+, AT150	+, AT150
+, AT105, AT120	+, AT105, AT120	+, AT105, AT120	+, AT105, AT120	+, AT105, AT120	+	AT150
+	+	+	+	+	+	+
+, AT120	+, AT105, AT120	+, AT105, AT120	+, AT120	+, AT120	AT150	+, AT150
AT120	AT105, AT120	AT105, AT120	+, AT120	+, AT120	+, AT150	+, AT150
+, AT120	+, AT120	+, AT120	+, AT120	+, AT120	+	AT150
+, AT120	+, AT120	+, AT120	+, AT120	+, AT120		+, AT150
+	+, AT120	+, AT120	+	+	+	+
+, AT160	+, AT120	+, AT120	+, AT105, AT120	+, AT105, AT120	+, AT150, AT160	AT150, AT106
			+, AT120		+, AT150	+, AT150
	AT105, AT120	AT105, AT120	+, AT120		+	+, AT150
+	+, Test	+, Test	+, Test	+, Test		+, AT140
+, AT101	+, Test	+, Test	+, AT120	+, AT120		
+, Test	+, AT120	+, AT120	+, AT120	+, AT120		+, Test
+, AT101	+, Test	+, Test	+, Test	+, Test		+, Test
+	+	+	+	+		+
+, AT101	+, AT101	+, AT101	+, AT101	+, AT101	AT140	+, AT140
+, AT101	AT101	AT101	+, AT101	+, AT101		+, AT140
+	+	+	+	+		+

*Substrates can vary in their surface properties, therefore adhesion tests prior to using are recommended
+ = good adhesion can normally be expected without primer.
Reference numbers (e.g. AT111) show the type of illbruck primer required to improve adhesion.
Where there is no result listed according to substrate please contact technical department.

Glossary

Benefits

	Acoustic Insulation to 60 dB		Below Grade Use		MAF (e.g. 25%)		Weather Resistant
	Airtight		Elastic		No Fixings Required		
	BBA Accredited		Fast Cure		Strong		

Certifications

ift

(Institute for Window Technology e.V.) ift Rosenheim is an internationally renowned, scientific services company for the window & façades industry. ift Rosenheim focus on the verification of fitness for use, dependent on intended use, of the servicable components of the building's fabric.



BBA

The BBA is the UK's major authority offering approval and certification services to manufacturers and installers supplying the construction industry. BBA Approval is recognised by building control, government departments, architects, local authorities, specifiers, and industry insurers like the NHBC.



CE

CE Marking on a product is a manufacturer's declaration that the product is assessed before being placed on the market and thus satisfies the legislative requirements (e.g. a harmonised level of safety) to be sold there. It means that the manufacturer has verified that the product complies with all relevant essential requirements (e.g. safety, health, environmental protection requirements) of the applicable directive(s).



BSI

tremco illbruck Limited - A company certified to: ISO 9001, ISO 14001 and ISO 18001.



Memberships



tremco illbruck and its strong brands



tremco illbruck is a European manufacturer and service provider of high-performance sealing, bonding, flooring, waterproofing and passive fire protection products for the construction and manufacturing industries.

We ensure that your processes become faster, smarter and more efficient.



illbruck adds perfection to all your sealing and bonding projects, be it windows, façades, interiors or exteriors, a major construction scheme or a minor refurbishment job. We offer the right set of products, services and expertise to lessen your workload and improve the overall environment within buildings - making it perfect.



Nullifire helps reduce the complexities of passive fire protection. Fire safety regulations can be complicated and potentially involve the threat of liability. To cope with these challenges we deliver a focused range of rigorously tested products that cover a wide array of passive fire protection applications. Nullifire's expert advice, support and training make for smart and simple solutions in passive fire protection.



TREMCO delivers lasting results when it comes to flooring, waterproofing, insulating glass or structural glazing. The building envelope is faced with ever more exacting requirements – technologically, legally and in terms of sustainability. With more than 85 years of experience, TREMCO offers products that have been tested for decades and under extreme environmental conditions – for buildings that are made to last.



2018-10



tremco illbruck Limited
Coupland Road, Hindley Green
Wigan WN2 4HT UK

T. +44 (0)1942 251400
F. +44 (0)1942 251410
sales.uk@tremco-illbruck.com
www.illbruck.co.uk

